

Tilt Test [TTPD2 A/V]



TILT TABLE

Frequent usage

Cardiology
Syncope Unit



TECHNOLOGY & EXPERIENCE
unique performance guarantee



www.gardhenbalance.it



Tilt Test [TTPD2 A/V]



SEAT BELTS

With quick release system.

DIGITAL DISPLAY

For precise and immediate display of tilt angle.

FOOT CONTROLS

For tilt angle and variable height adjustment.

WHEELS

They allow transport of the device from place to place.

FEET OF LEVELING

They provide greater stability by optimizing contact with the floor.



Standard equipment

- Swivel wheels for transportation.
- Parking and leveling feet.
- Linear actuator for plane movement.
- Movement damping device.
- High-density lowered mattress.
- Upholstery made of class 11M leatherette, a material that can be sanitized with commonly used detergents and medical surgical aids, with antibacterial, antifungal, stain-resistant properties. Color customization upon request - Equipment code AC87/1.
- Digital display with position display at grade unit.
- Device for quick electromechanical release in the absence of voltage.
- One-sided grip.
- Quick-release seat belt set-as per cover image.
- Dual remote foot control and flexible connecting cable.
- Provision for accessories.
- Lighted double-pole thermal circuit breaker.
- Equipotential node.
- Rated speed uphill 10° every 2.5".
- Rated downhill speed 10° every 1.75".
- Variable table height from mm 528 to mm 928 or from 560 to 860 (with extra stroke accessory code TTXC).
- Lever for quick release-quick plane descent in 2".
- Emergency button for dynamic plane, rapid clinostatism (0°) automatic, with LED light (TTPE).
- Footrest integral with the structure, with semi-rigid base and thick transparent PVC protection.

The motorized dynamic plane, normally used for passive postural variation or Tilt test. It finds further use in such areas as: **physiotherapy, rehabilitation, ultrasound examinations** and wherever it is necessary to examine a patient in optimal postural condition. Large-capacity motor unit, powered by low voltage and operated by foot controls, ensures dynamic plane variation. Two nitrogen pistons also follow the rotation of the dynamic plane, promoting rapid, precise postural variation without abrupt acceleration.

Do you want to change the color of the upholstery and frame?

Frame or click the QR codes and find out how to personalize the device by consulting our color cards*.

*If no preference is expressed, the device will be supplied with the available color.

Coating
Leatherette

Coating
Silicon

Frame



Movements

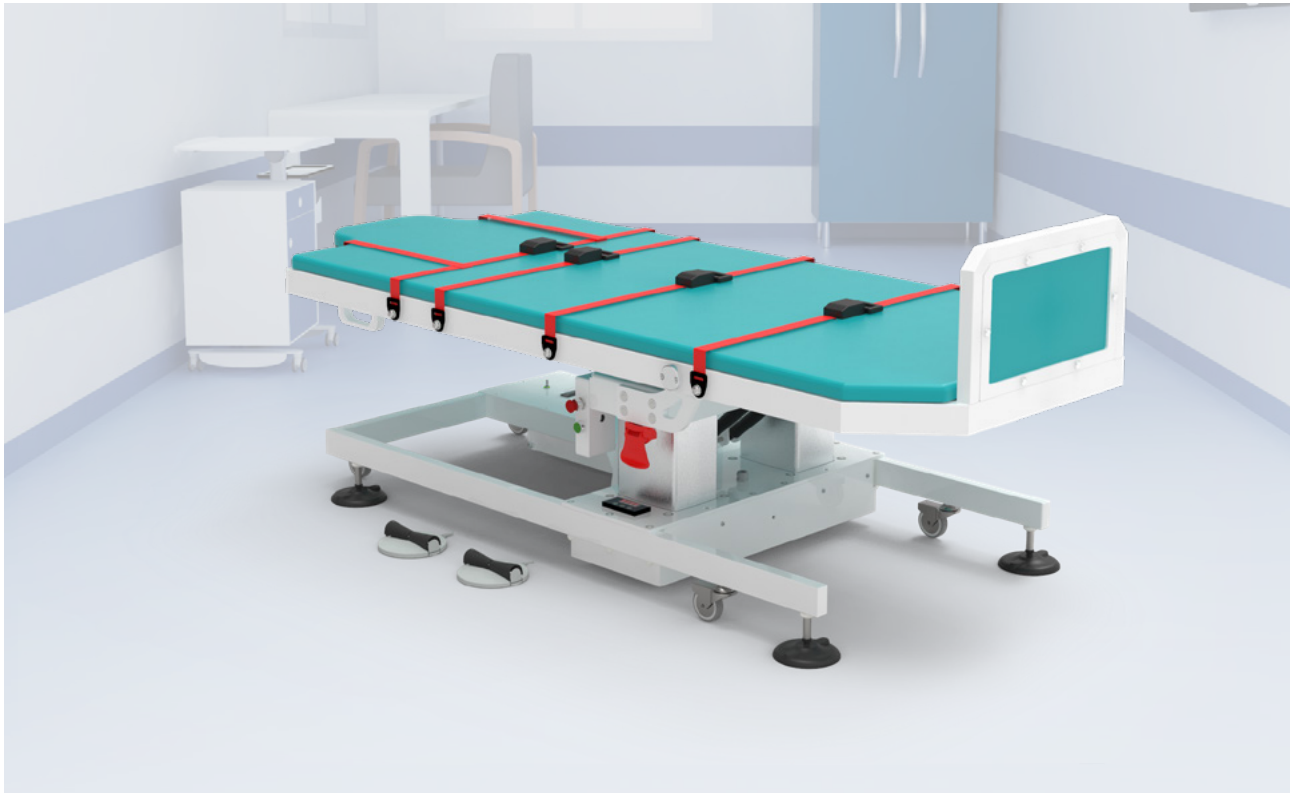

CLINOSTATIC POSITION



ORTHOSTATISM MAX 85°



Movements

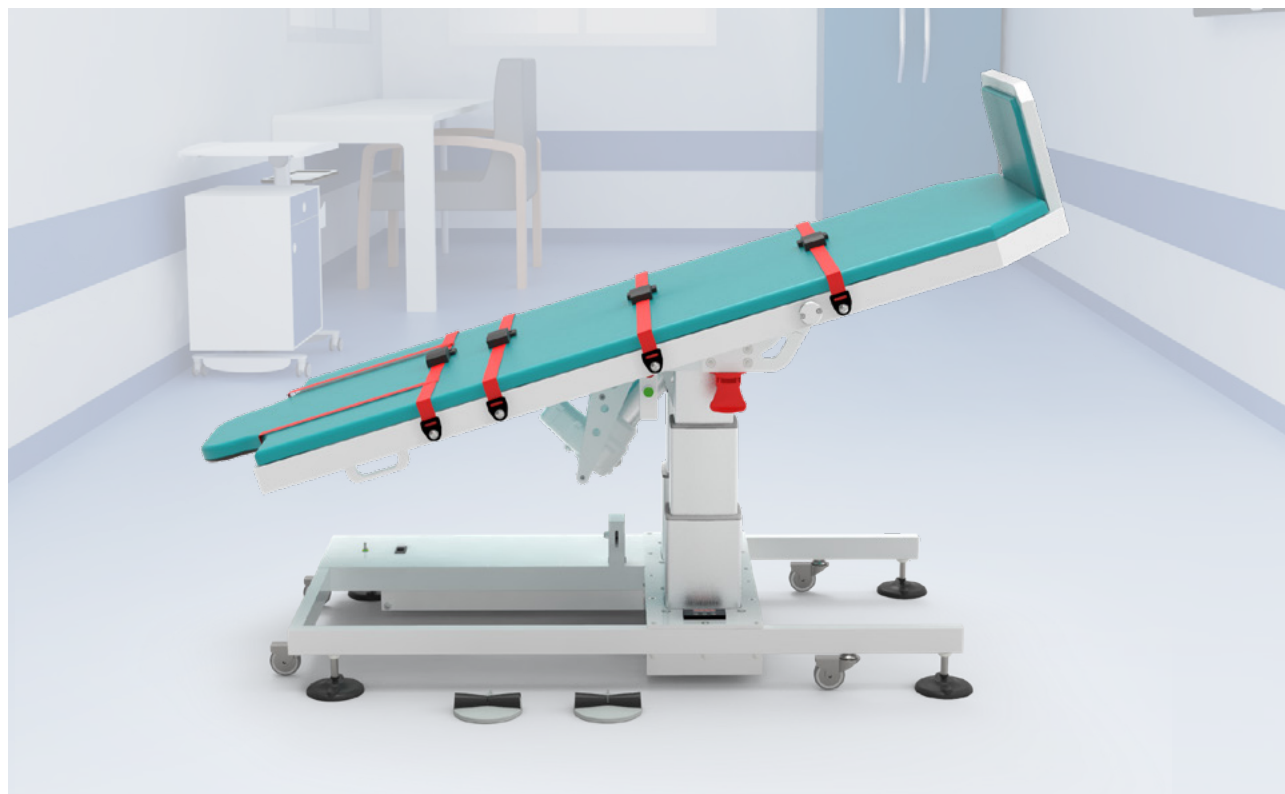

TRENDELENBURG - 20°



THE MOTORIZED DYNAMIC PLANE HAS A HIGH RANGE
FROM +85° (ORTHOSTATISM) TO -20° (TRENDELENBURG)



Movements

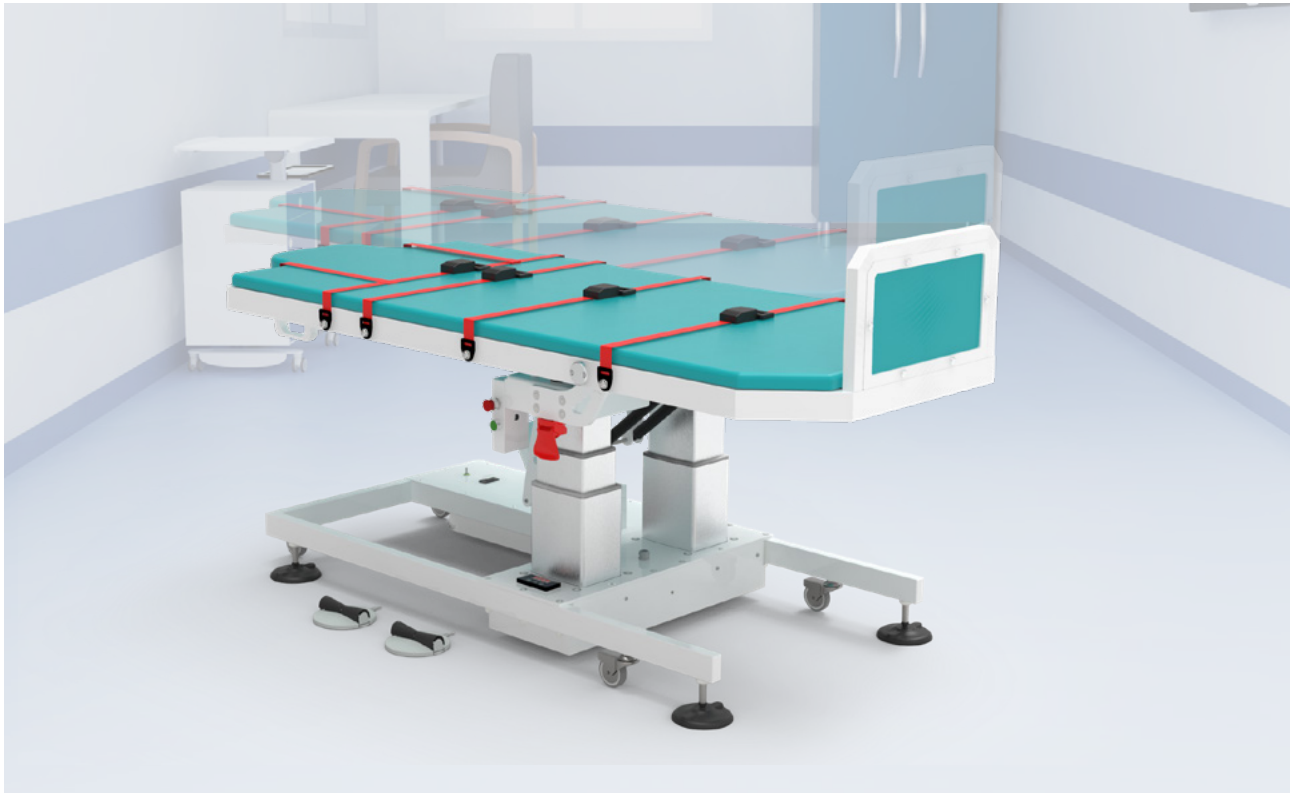

VARIABLE HEIGHT



Optional components available

TTSP



Sliding dynamic plane armrest adjustable in height and tilt.

TTPR



Motorized footboard adjustable in height.

TTUP



Safety belts for pediatric use.



TTXC

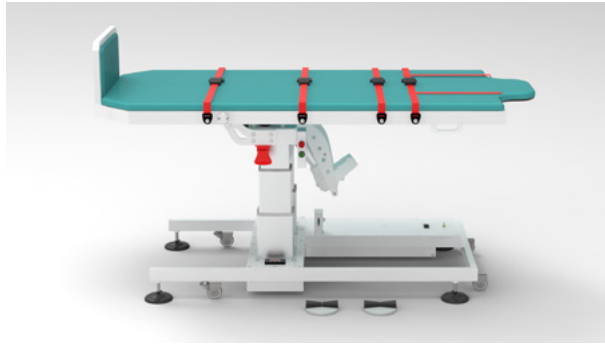

Extra stroke height variable from mm 560 to mm 860.

TTSV



Speed version with 2 motors included, that allow you to increase the speed of movement. Rated speed uphill 10° every 1.5"; Rated downhill speed without quick release 10° every 0.7".

TTAF



IV pole on wheels.



Size table

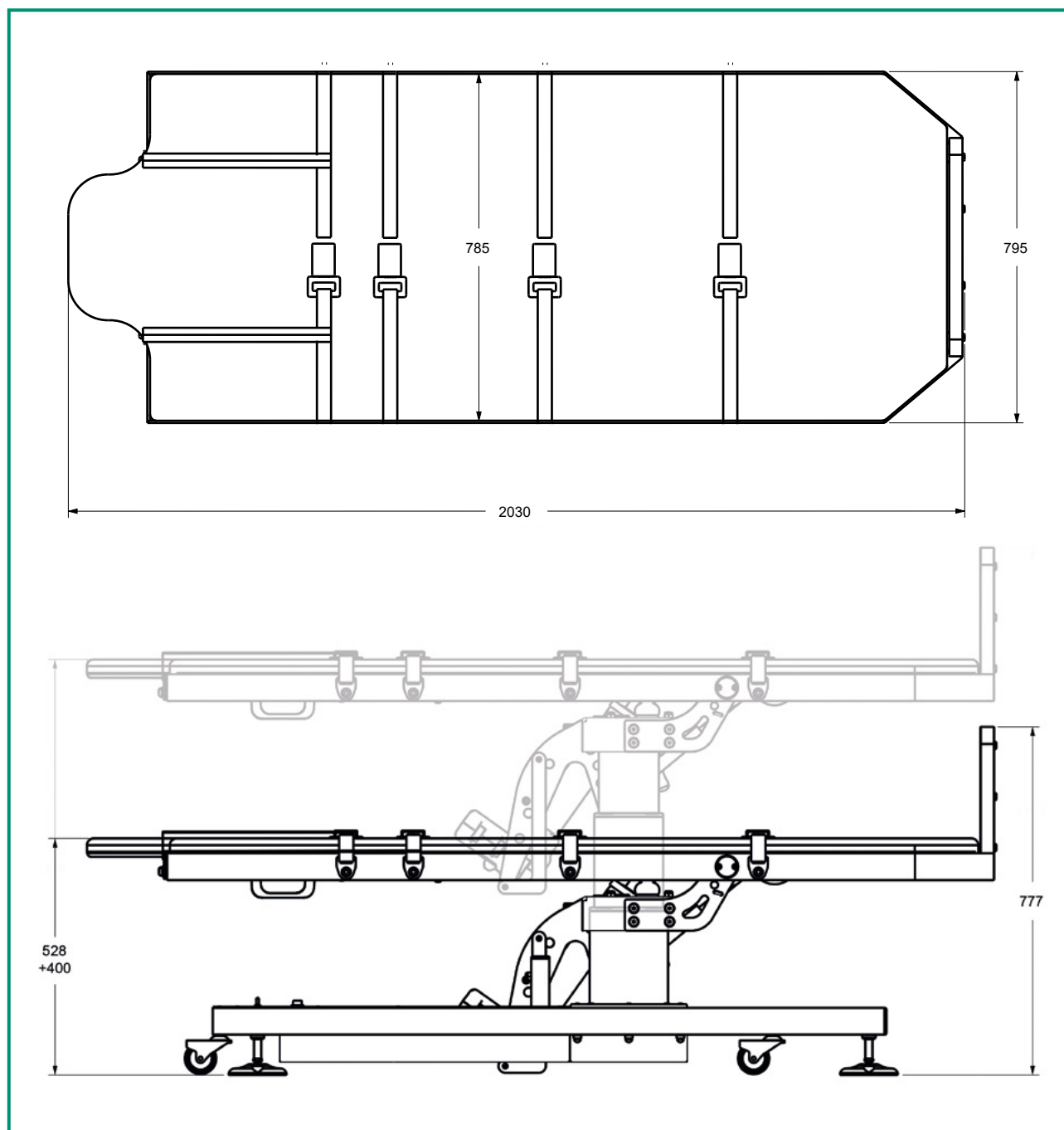

Main Cord



Type F - Schuko



Type L - 16A



Type I - Australia



Type B - Canada and USA



Type G - UK plug



Data sheet

CND/EMDN	Z120616
GMDN	42577
Basic UDI-DI	805771740GB0031.SP6U
No. progressive/R	2442996/R
Product Code	GB0031.SP
Intended Use	Devices intended for patient accommodation during hospitalization and medical examinations and procedures in general.
Manufacturer	GARDHEN BALANCE SRL
Total weight	150 kg
Maximum Scope	150 kg
Safe Workload	185 kg
Wheels	No. 4 Swivel Ø 60 mm
Stationing and leveling	Via adjustable feet
Power supply	230 V / 50-60 Hz
Absorption	4A
Insulation	IP 54
Rated speed uphill"	10° every 2.5
Rated downhill speed without quick release	10th every 1.75"
Rated speed uphill with TTSV accessory	10° every 1.5"
Rated downhill speed with TTSV accessory without quick release	10° every 0.7"
Rated downhill speed with quick release	2" - standard equipment
Rated downhill speed with quick release	10° every 0.3"
Exclusion from the network	Via luminous bipolar thermal circuit breaker
Equipotentiality	Knot clamp
Security	<ul style="list-style-type: none">• Electromechanical device for quick release of the plane in the absence of electric power.• Thermal protection.• Safety nut.• No. 3 adjustable, quick-release restraint belts for adults and children
Display in degrees	Via digital display with readout at grade unit with bright LEDs. Digit h 20 mm
Max strength	7000 N
Commands	Double foot switch
Orthostatism	+85°
Trendelenburg	-20°

Gardhen Balance S.r.l.

Via G. Luraghi c/o Consorzio Il Sole - lot S - 80038 Pomigliano d'Arco (NA) - Italy

Tel. +39.081.8692160 pbx - Fax +39.081.8692460

E-mail: info@gardhenbalance.it - PEC: gardhenbalance@pec.it

Visit our website www.gardhenbalance.it / Follow us on



Images reproduced in this sheet are for reference only and dimensional values are nominal. It is the manufacturer's right to make changes to the designs without prior notice. Refer to the optional components catalog and/or commercial proposals for identification of standard equipment and selection of any additional components. In case of discrepant data, the contents of the commercial proposals shall prevail. For regulatory references, please refer to the user manual and declaration of conformity.

Dep. EN_79 rev. 26/03/2025