

# Athena Scale

Multifunctional chair  
with integrated weighing system



THERAPY CHAIR WITH  
INTEGRATED SCALE

Frequent Usage

Dialysis  
Emergency Room



High

COMFORT

Inpatient and outpatient therapy



[www.gardhenbalance.it](http://www.gardhenbalance.it)



## Standard equipment

### Display - GB Touch Console

handling and weighing system management.



**Armrests ergonomic multi-adjustment and equipped with hand control support.**





## Standard equipment

### Armrest Movements



Sinchronized with the backrest

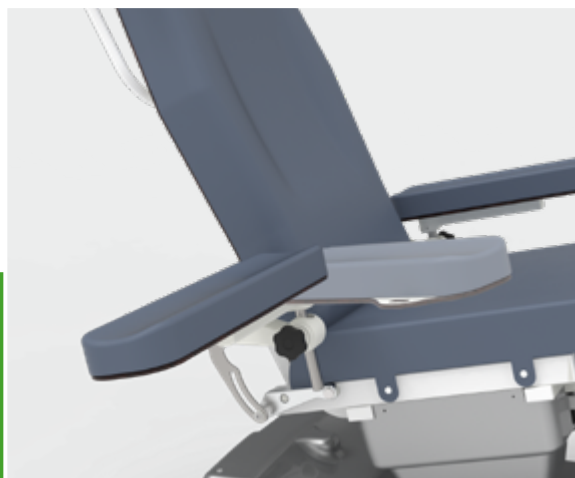

Swivable

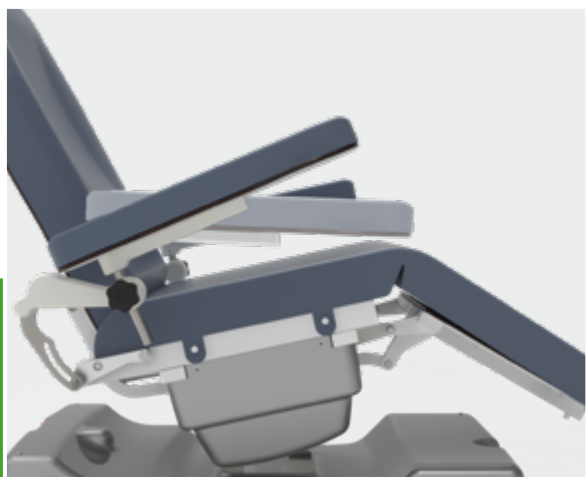

Tiltable



Folding



Variable Height



Removable



## GB Touch

### Control panel for electrical movements

The display-console GB Touch enables all electrical movements of the device to be managed through the dedicated control panel.



## MANAGEMENT OF ELECTRICAL MOVEMENTS

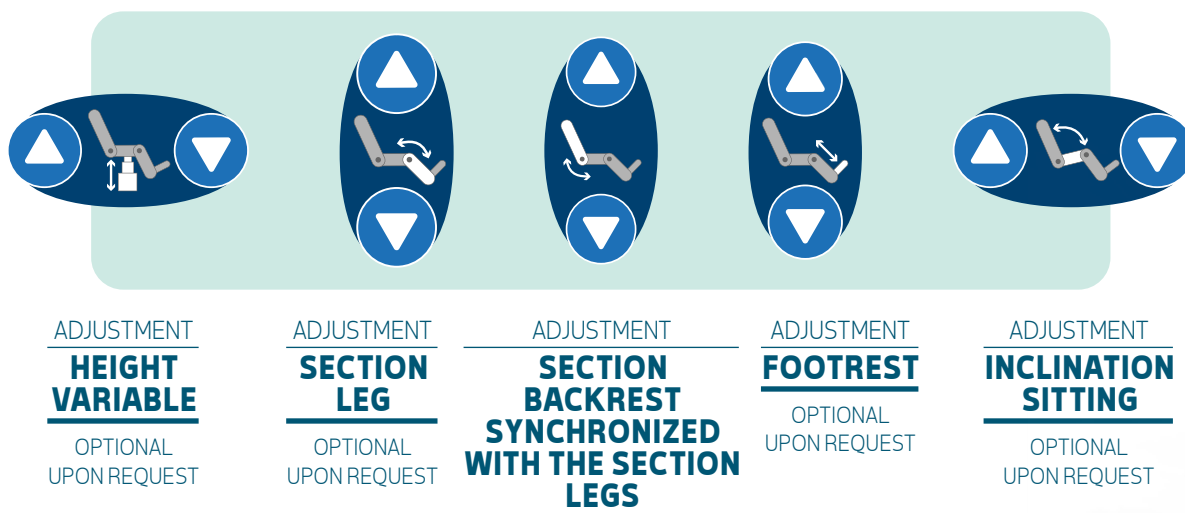

### For more information from the GB Touch

Frame or click the QR code button and discover all the features and potential of the display.



## Movements

### TRENDELENBURG

The Trendelenburg position can be obtained through dedicated buttons on the hand control and on the display-console GB Touch.



Activation by

#### GB Touch



Activation by

#### Handset



## Movements

Input/output position



Activation by

#### GB Touch



Activation by

#### Handset







## GB Touch

### Scales Display and Control/Management Console

The chair is equipped with 10.1" HD Touch Screen Display with 160° viewing angle useful for managing the **integrated weighing system** and all **movements** of the device.

**GB Touch display**  
integral to the  
structure/frame  
of the chair

**Display Bilancia**  
with interface graphics for  
managing the **weighing system**





## Features of GB Touch

- Power on via Soft Touch Key
- Movement management
- Low voltage power supply
- Plastic indicator box with IP65 insulation
- Battery status indicator
- Display lighting control
- Screen saver
- Night mode
- Smart Functions
- Full control via android/ios/windows app GBSmart
- Scheduled maintenance setting
- Language setting: Italian - English - French - Spanish - German
- Digital protection against accidental or unwanted access.



## Features and functionality of the weighing system

- Weight reading via 10.1" HD touch screen display
- Patient master data
- Patient location indication
- Tare: automatic and manual always visible
- Unit indicator: unit of measure selectable between kg and lbf
- Capacity 200kg;
- Minimum division double scale automatic display:  
50 g up to 150 kg - 100 g from 150 kg up to 200 kg.
- Converter: 24bit, 10,000 divisions
- Weight loss alarms
- Patient descent alarms
- Access log
- Remote parameter control
- Automatic data transmission to enabled ports
- Porta Ethernet 10/100
- Optional: Wi-Fi/Bluetooth combo module - USB A port for weight data transmission - USB B port for external printer connection - RS-232 port - RS-485 port.
- Backup battery to ensure autonomy of weighing system in power failure - equipment code AC17/P



## Other features of the medical device

- Thermoset powder coated steel frame.
- Top divided into 3 sections: back, seat and legs.
- Headrest integral to the backrest
- Simultaneous movement of back and leg sections by 1 motor.
- Trendelenburg position.
- Armrests integral with backrest movement, removable, with swivel function, tiltable up/down, tiltable 90°; equipment code AC30/C1 (see accessory catalog for other type of armrests).
- No. 4 durable, antistatic, stainless, swivel casters ø 100 mm.
- Simultaneous brake galvanized steel rear wheels - Equipment code AC7P1G.
- All chair movements are controlled by a perimeter hand control equipped with a 3.5 m coiled cable. The hand control is easy to use as it is made with large raised pictograms and is also suitable for visually impaired patients. The hand control has 10 keys with 2 memories. For patient safety, the hand control is equipped with a key to inhibit commands - Equipment code AC34P. Insulation IP66.
- Double-sided push-button panel support - Equipment code AC25P.
- ABS cover for base - Equipment code AC83.
- ABS seat cover - Equipment code AC84.
- Soft foam cushions of the seat/leg section easily removable.
- Fire-retardant leatherette upholstery UNI 9175/87 and 9175FA-1/94 class 1M - Equipment code AC87/1.
- Touch screen display, located on the back of the backrest - Equipment code AC167.
- Integrated weighing system.

### Do you want to change the color of the upholstery and frame?

Frame or click the QR codes and find out how to customize your device by browsing our color cards\*.

\*If no preference is expressed, the device will be supplied with the available color.

**Upholstery  
Letheurette**

**Upholstery  
Silicon**

**Frame**



### Do you want to improve the device?

Frame the QR code and discover all the components optional available





## Dimension table standard versions

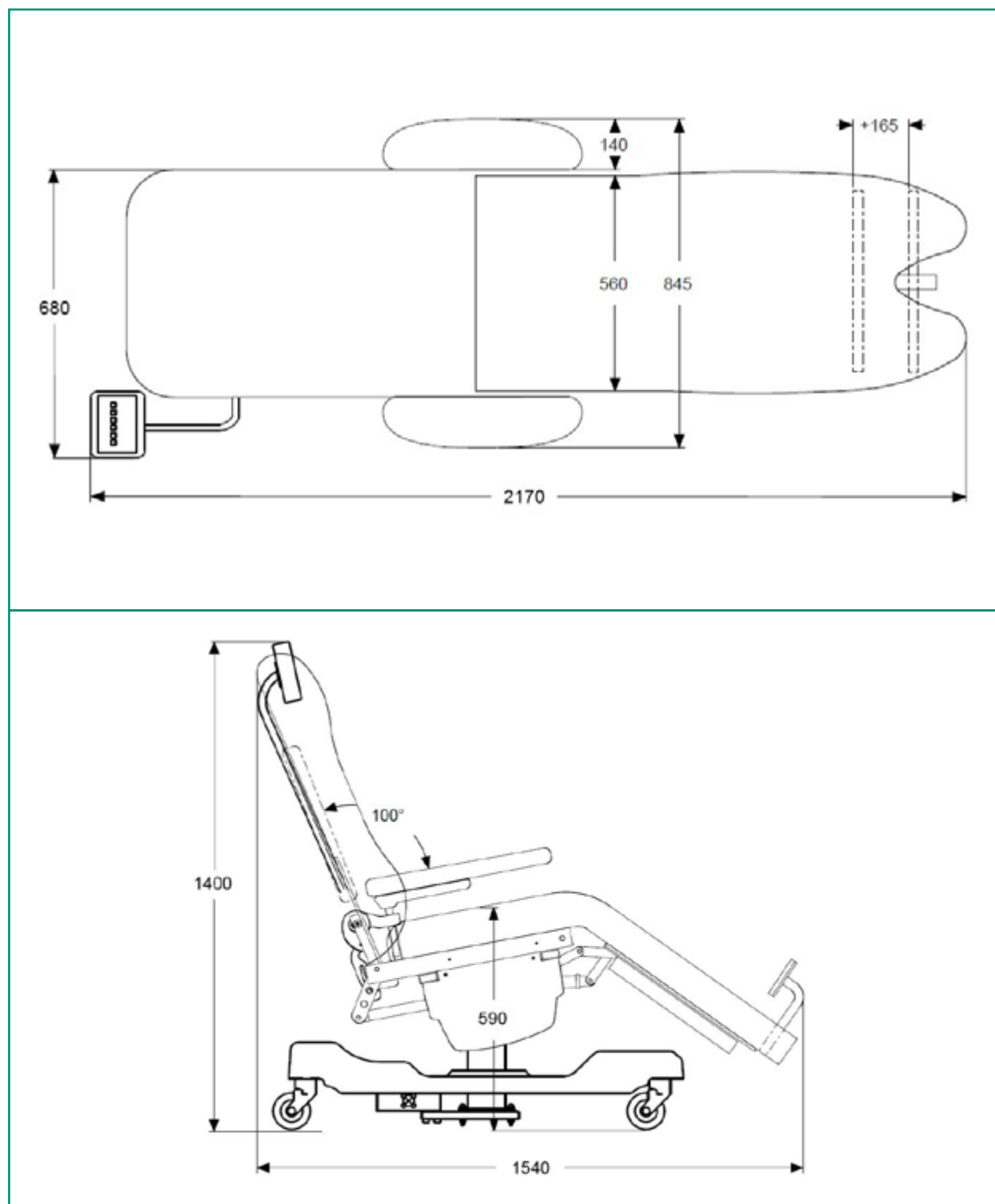

## Main cord



**Type F**  
**Schuko**



**Type L**  
**16A**



**Type I**  
**Australia**



**Type B**  
**Canada and USA**



**Type G**  
**UK plug**



## Data sheet

CND and EMDN	<b>V08020102</b>
GMDN CODE	<b>35322</b>
UDI-DI di Base	<b>805771740POLBJK</b>
No. progressive/R	<b>2576580/R</b>
ID Product	<b>GB0179.SP</b> Steel painted
Intended Use	Armchair scale for mass determination in medical practice in the context of weighing patients for reasons of control, diagnosis and treatment.
Manufacturer	GARDHEN BILANCE SRL
Device weight	Standard 70 kg
Type of control	Touch Screen Display - Keypad
Battery	Autonomy 10 cycles
Weighing system batteries	24 V self-rechargeable (approximately 24 hours of battery life)
Power supply	Multivoltage 100-240 Vac 50-60 Hz
Power cord type	Schuko or other upon request
Wheels	No. 4 stainless swivel 100 mm with braking system
Electric motors	Low voltage (24 V)
Max absorption	4A
Insulation	IP44
Max load capacity	Standard 200 kg
Safe Workload	Standard 235 kg
Minimum division	With capacity up to 200 kg division display minimum 50g up to 150kg: 100g from 150kg up to 200kg.
Box display	Plastic viewer box with IP65 insulation
Converter	24bit
Display	Touch screen
Display power supply	24 Vdc
Alarms	Excessive or insufficient weight drop alarm / Patient drop alarm / Brake not engaged alarm / Brake not engaged light alarm / Battery status indicator / Guarsti alarms / Maintenance due alarms
Data transmission	Ethernet port 10/100 Optional: Wi-Fi/Bluetooth combo module - USB A port for weight data transmission - USB B port for external printer connection - RS-232 port - RS-485 port.
I/O (opz.)	4 outputs
Anti-black-out function	Battery and Software
Tare	Tare subtractions before and during dialysis
Tare mode	Automatic and manual
Compliance	EU Regulation 2017/745 Certificate No. 126/MDR issued by O.N. 0051 Meets, of course , all applicable standards and directives

### Gardhen Balance S.r.l

Via G. Luraghi c/o Consorzio Il Sole - lotto S - 80038 Pomigliano d'Arco (NA) - Italy

Tel. +39.081.8692160 pbx - Fax +39.081.8692460

E-mail: [info@gardhenbalance.it](mailto:info@gardhenbalance.it) - PEC: [gardhenbalance@pec.it](mailto:gardhenbalance@pec.it)

Visit our website [www.gardhenbalance.it](http://www.gardhenbalance.it) / Follow us on     



Images reproduced in this sheet are for reference only and dimensional values are nominal. It is the manufacturer's right to make changes to the designs without prior notice. Refer to the optional components catalog and/or commercial proposals for identification of standard equipment and selection of any additional components. In case of discrepant data, the contents of the commercial proposals shall prevail. In the event that preferences are not expressed regarding the colors of the devices ordered, the same, will be made in the colors shown in the data sheet/brochure. For regulatory references, please consult the user manual and declaration of conformity.

Dep. EN. 104 rev. 06/05/2024