

Stephen Scale H Anatomical

Multifunctional seating
with integrated weighing system



THERAPY CHAIR WITH
INTEGRATED SCALE

Frequent Usage

Dialysis
Emergency Room



Hight
COMFORT

Inpatient and outpatient therapy



www.gardhenbalance.it



Standard equipment

removable upholstery
to facilitate the activities
of sanitising
the device.



Display - Console GB Touch
management of the movements and weighing system.



Standard equipment

**Ergonomic,
multi-adjustable
armrests**



**Synchronized to the
Backrest**



Rotating



Tiltable



Overturnable



GB Touch

Control panel for electrical movements

The GB Touch display-console allows all electrical movements of the device to be managed via the dedicated control panel.



MANAGEMENT OF ELECTRICAL MOVEMENTS

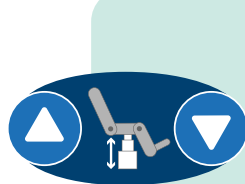

ADJUSTMENT
**HEIGHT
VARIABLE**
AVAILABLE
ON REQUEST



ADJUSTMENT
**LEG
SECTION**
AVAILABLE
ON REQUEST



ADJUSTMENT
**BACKREST
SECTION
SYNCHRONIZED
WITH THE
LEG SECTION**



ADJUSTMENT
FOOTREST
AVAILABLE
ON REQUEST



ADJUSTMENT
**SEAT
INCLINATION**
AVAILABLE
ON REQUEST



For more information about the GB Touch

Frame or click the QR code button and find out all the features and potential of the display.



Movements

Synchronized backrest and leg sections

The movements of the synchronised backrest and leg sections are controlled by dedicated buttons on the push-button panel and on the GB Touch display-console.



ANOTHER EXAMPLE
OF HANDLING::

Recliner Position

Activated on the push-button panel and display - GB Touch console via movement management keys.

Activated by
GB Touch



Activated by
Handset

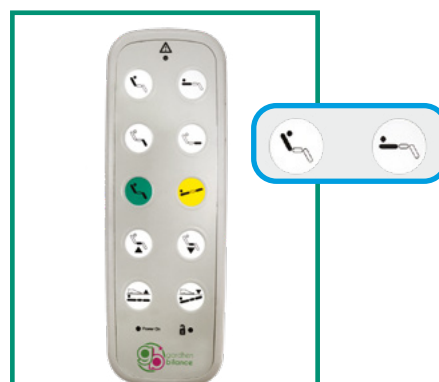



GB Touch features

- Switch-on via Soft Touch Button
- Movements management
- Low voltage power supply
- Indicator box in plastic material with IP65 insulation
- Battery status indicator
- Display lighting control
- Screen saver
- Night mode
- Smart functions
- Complete control via GBSmart android/ios/ windows application
- Scheduled maintenance setting
- Language setting: Italian - English - French - Spanish - German
- Digital protection against accidental or unwanted access



Features and qualities of the weighing system

- Weight reading via 10.1" HD touch screen display
- Patient's biographical data
- Patient's location indication
- Tare: automatic and manual. This value is always displayed on the screen
- Unit of measurement indicator: unit of measurement can be selected between kg and lb
- Capacity 200kg
- Minimum division double scale automatic display:
 - 50 g up to 150 kg - 100 g from 150 kg up to 200 kg.
- Converter: 24bit, 10,000 divisions.
- Weight loss alarms.
- Patient descent alarms.
- Access register.
- Remote parameter control
- Automatic data transmission to enabled ports
- Ethernet port 10/100
- On request : Wi-Fi/Bluetooth combo module - USB A port for weight-data transmission - USB B port for external printer connection - RS-232 port - RS-485 port.
- Buffer battery to ensure autonomy of the weighing system in the event of a power failure - Equipment code AC17/P



Other features of the medical device

- Painted steel frame in thermosetting powder.
- Lying surface divided in 4 sections (headrest, backrest, seat and leg).
- Simultaneous movement of the back section and the leg section through 1 motor.
- Trendelenburg position .
- Headrest joint to the backrest.
- Armrest's movements synchronized with the backrest. The armrests are completely removable and can be rotate, tilted and overturned at 90°; (please refer to the accessories catalogue for other version of armrests).
- No. 4 wheels ø 100 mm antistatic, sturdy, stainless and swivable.
- Simultaneous brake on rear wheels in chromed steel - Equipment code AC7P1G.
- Chair's movements are controlled by handset with a 3,5 mtl coiled cable. The handset is user friendly and has visual pictograms useful for partially sighted people. Handset is equipped by 10 buttons with 2 memories. For patient's safety purpose the handset is provided with an inhibition key - Equipment code AC34P. Insulation IP66.
- Bilateral handset support - Equipment code AC25P.
- ABS base cover - Equipment code AC83.
- ABS seat cover - Equipment code AC84.
- Easily removable soft foam independent cushions.
- Upholstery in flame retardant leatherette UNI 9175/87 e 9175FA-1/94 class 1IM - Equipment code AC87/1.
- Digital multifunction scale display, placed on the back of the backrest - Equipment code AC167.
- Integrated weighing system.

Do you want to change the colour of the upholstery and frame?

Frame or click the QR codes and discover how to personalise your device by consulting our colour cards*.

*If no preference is expressed, the device will be delivered in the available colour.

**Upholstery
Leatherette**

**Coating
Silicon**

Frame



Do you want to improve the device?

Scan the QR Code to find out all the available accessories listed on our catalogue.





Technical sheet

CND / EMDN Code	V08020102
GMDN Code	35322
Progressive/R	2512311/R
UDI-DI di base	805771740POLBJK
ID Product	GB0009.SP Painted steel GB0009.SS Stainless steel
Inteded use	Chair with integrated scale for weight determination of the patient for assessment, diagnosis and care purposes
Manufacturer	GARDHEN BILANCE SRL
Overall weight	70 kg
Type of control	Display Touch Screen - push-button panel
Battery	10 cycles of autonomy
Battery weighing system	24 V self rechargeable (autonomy approx. 24 hours)
Power	Multivoltage 100-240 Vac 50/60 Hz
Main cable	Schuko or other upon request
Wheels	No. 4 Ø 100 mm swivable and stainless with braking system
Electric motors	Low voltage (24 V)
Insulation	IP44
Max load	200 kg
Safety working load	235 kg
Divisions	With a max load capacity of 200 kg automatic displaying of the minimal division of 50 g up to 150 kg - 100 g from 150 kg up to 200 kg
Load cell power	5Vcc (from 1 to 4)
Display box	Display box in plastic material with IP65 insulation
Display	Touch Screen
Power display	24 Vdc
Alarms	Status indicator Luminous on display and on control systems Alarms Excessive or insufficient weight loss / Patient exit alarm / Brake disconnection alarm / Brake disconnection luminous alarm / Battery status indicator / Faults indicator / Maintenance deadline alarm
Data transmission	Ethernet port 10/100 On request : Wi-Fi/Bluetooth combo module - USB A port for weight-given transmission - USB B port for external printer connection - RS-232 port - RS-485 port..
I/O (opz.)	4 output
Antiblack-out function	Extra battery + software
Tare	Tare subtraction before and during the treatment
Tare modalities	Automatic and manual
Conformity	Regulation UE 2017/745 Certificate No. 126/MDR issued by O.B. 0051 It meets all applicable standards and directives



Dimensions

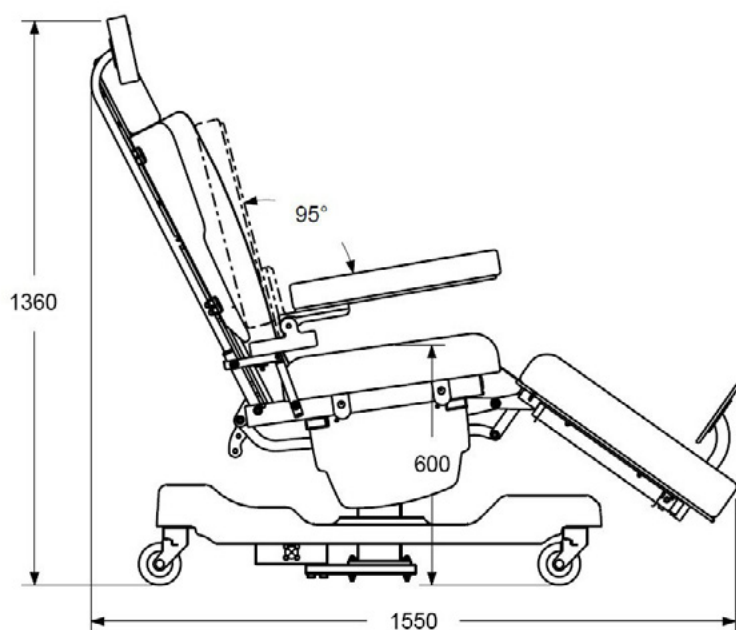
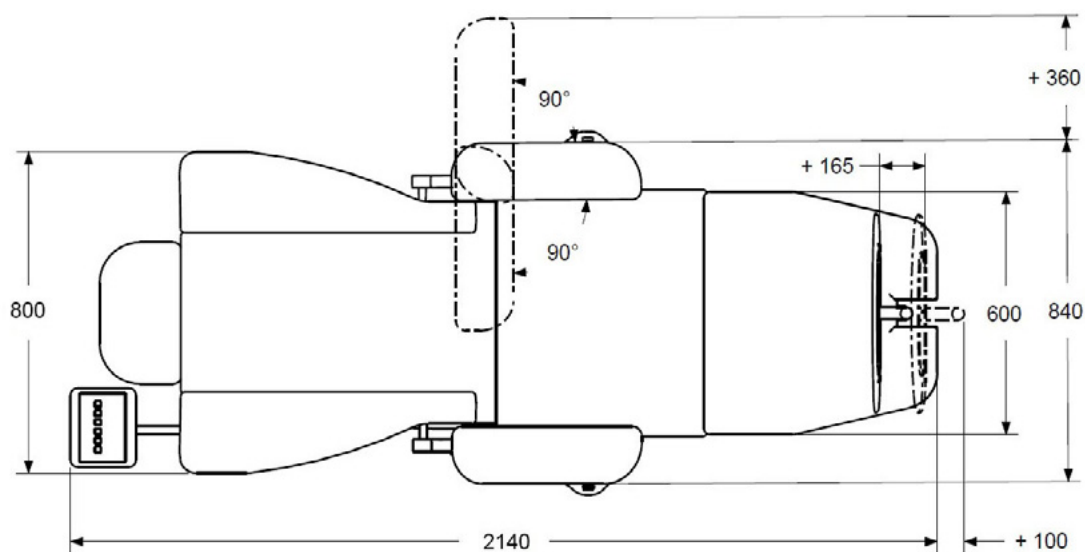

Main cord



Type F - Schuko



Type L - 16A

Type I -
Australia

Type B - Canada and USA



Type G - UK plug

Stephen Scale H Anatomical

Multifunctional seating
with integrated weighing system

www.gardhenbalance.it



Gardhen Balance S.r.l.

Via G. Luraghi c/o Consorzio Il Sole - lotto S - 80038 Pomigliano d'Arco (NA) - Italy

Tel. +39.081.8692160 pbx - Fax +39.081.8692460

E-mail: info@gardhenbalance.it - PEC: gardhenbalance@pec.it

www.gardhenbalance.it / Follow us



Pictures contained in this brochure is for illustrative purpose only. The manufacturer reserves the right to modify the projects without notice. For accessories identification please refer to the accessory catalogue or commercial offer. When data are different please refer to commercial offer.

Dep. EN 100 rev. 16/04/2024